

60's
76,1

korzysta = 2 skomponowane

7300

3800

3800

3300

200+

NAPĘD

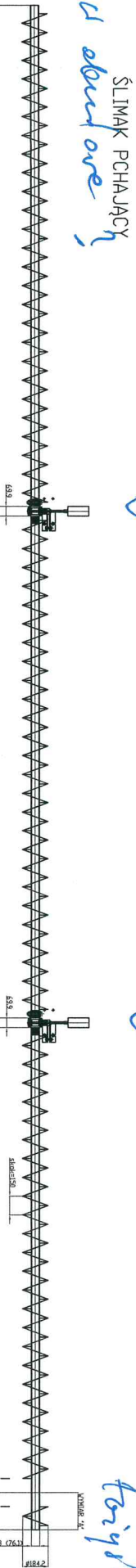

2,5

ŚLIMAK ~~ETA~~ PCHAJĄCY

1

2

3

podporowe

300

3000

3000

3000

3000

200

NAPĘD

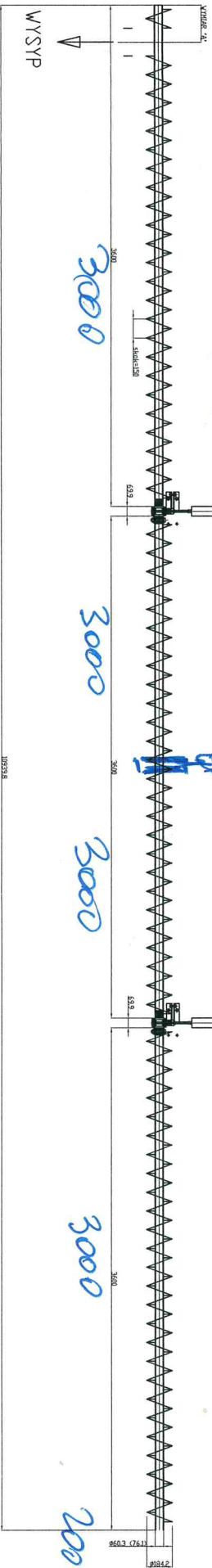

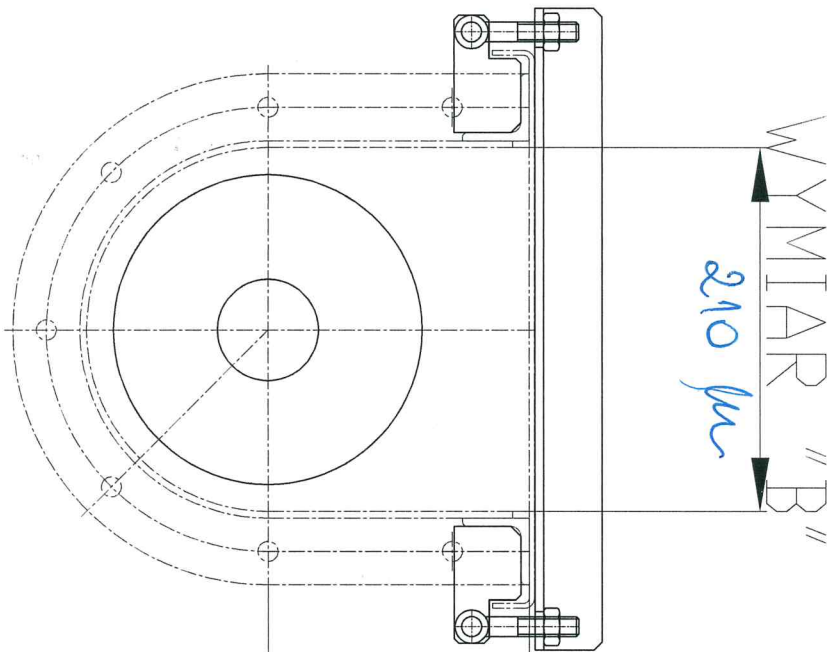

WYMIAR "B"
210 mm

x helty

WYMIAR "C"

~~120~~
~~115~~
120 mm