

NOTES:

- THIS DRAWING SHALL BE INTERPRETED IN ACCORDANCE WITH ASME Y14.100 WITH THE ADDITION OF APPENDICES B THROUGH E.
- THE FOLLOWING ARE MANDATORY WHEN INDICATED BY ■
 - REMOVE BURRS ■ BREAK SHARP EDGES .010 MAX
 - FILLETS R.010 MAX
 - $\sqrt{63}$ ALL OVER, EXCEPT AS NOTED
 DIMENSIONS APPLY:
 - BEFORE PLATING OR PAINTING
 - AFTER PLATING
 - AFTER PAINTING
 - TOLERANCES ON STOCK MATERIAL SIZES, SHALL BE AS SPECIFIED IN APPLICABLE SPECIFICATIONS.
- FINISH: POLISH TO REMOVE PITS, SCALE AND MACHINE MARKS.
- MATERIAL: UNS S17400 (TYPE 630) IN ACCORDANCE WITH ASTM A564. HEAT TREAT TO CONDITION H900.
- PERMANENTLY STENCIL OR ENGRAVE APPROXIMATELY AS SHOWN IN ACCORDANCE WITH MIL-STD-130.
- LASER ETCH IN APPROXIMATE AREA SHOWN, IN .25 INCH HIGH CHARACTERS, IN ACCORDANCE WITH MIL-STD-130 AS "20057635" "LL-ERG-7473"

REVISIONS				
ZONE	LTR	DESCRIPTION	DATE	APPROVED
B3, B2	4	REMOVED GAP	7/10/2017	

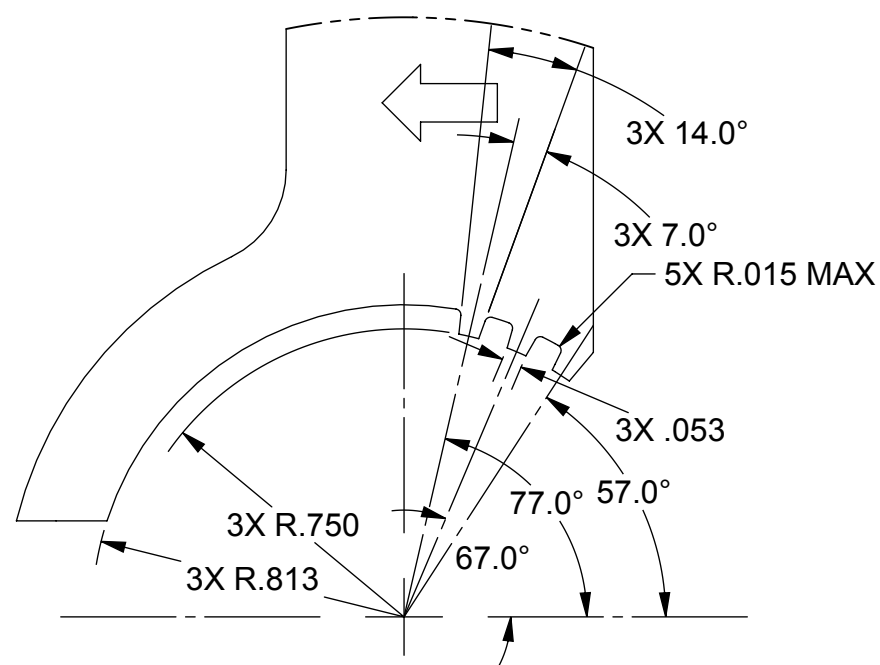

DETAIL A
SCALE 2 : 1

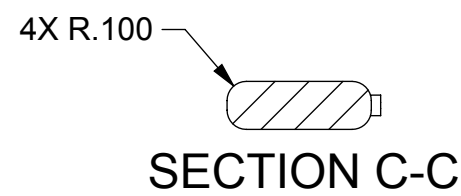

SECTION C-C

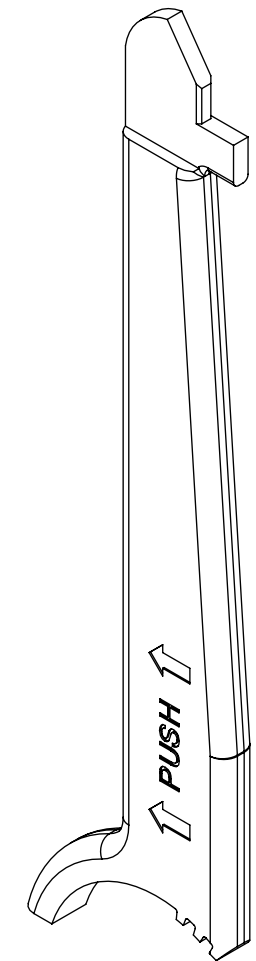
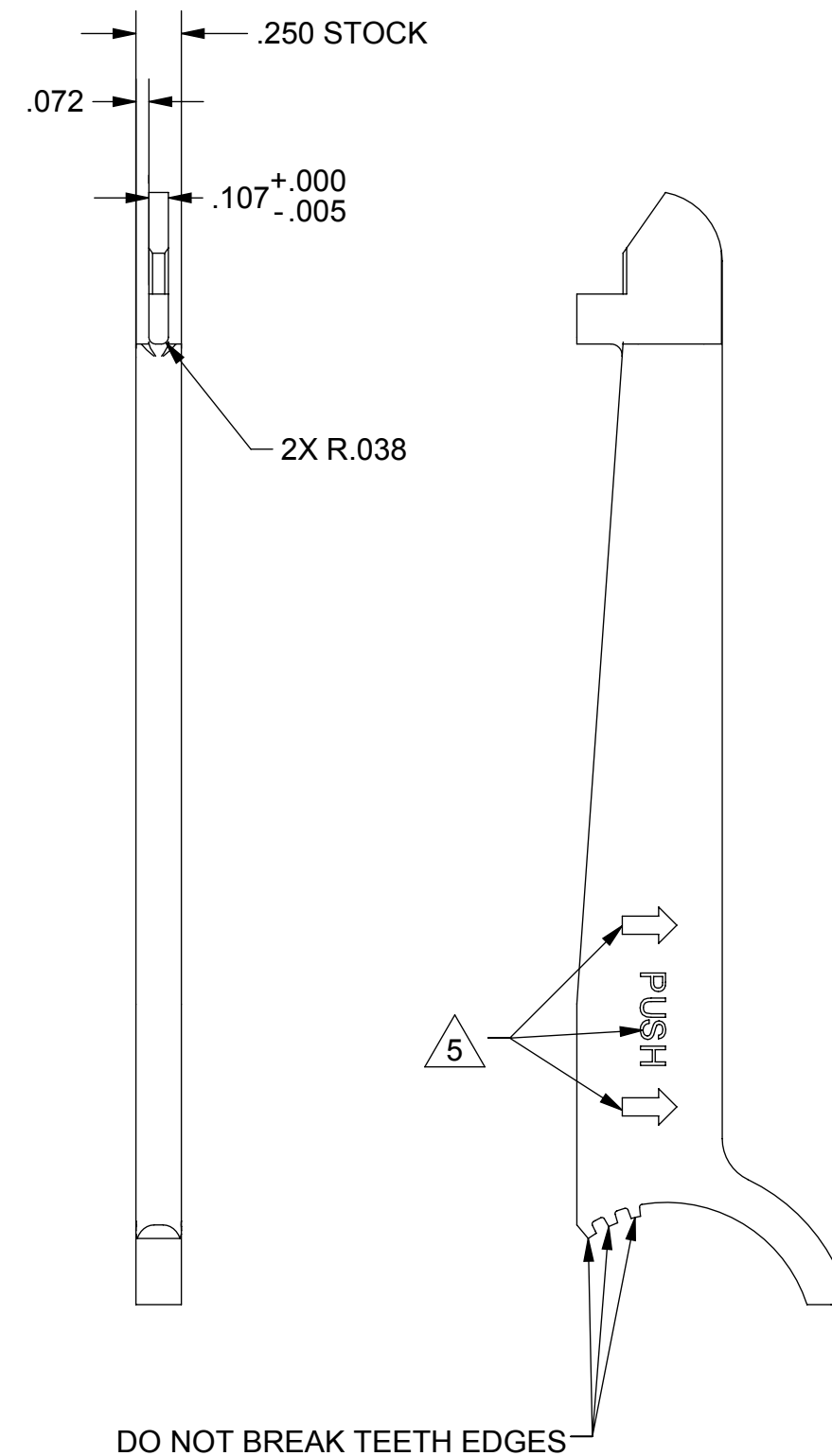
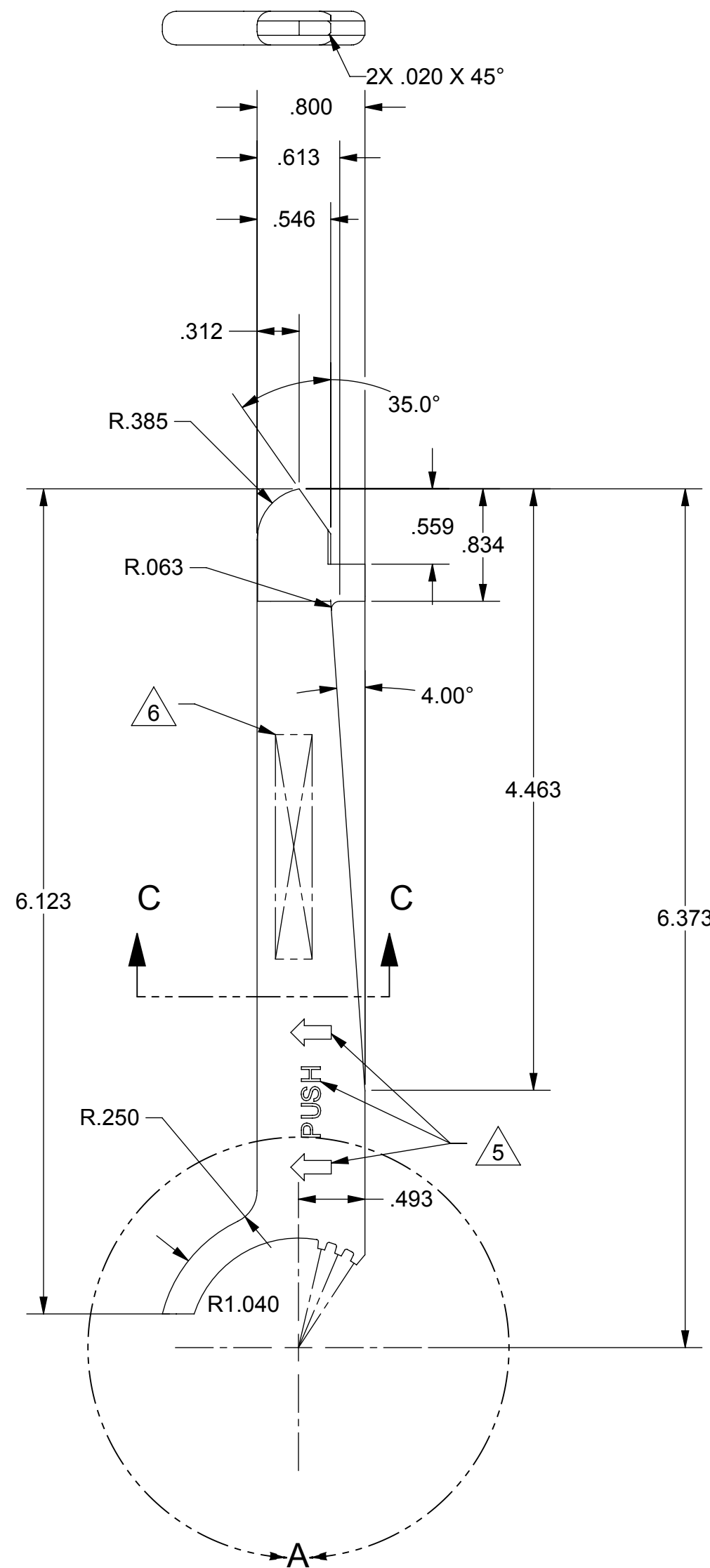

OFFICIAL USE ONLY
 MAY BE EXEMPT FROM PUBLIC RELEASE UNDER THE FREEDOM OF INFORMATION ACT (5 U.S.C. 552), EXEMPTION NUMBER AND CATEGORY: EXEMPTION 3-STATUTORY EXEMPTION

DEPARTMENT OF ENERGY REVIEW REQUIRED BEFORE PUBLIC RELEASE

NAME/ORG: E. CLAYTON / T12 DATE: 7/10/2017
GUIDANCE: N/A

EXPORT CONTROLLED INFORMATION

WARNING - THIS DOCUMENT CONTAINS TECHNICAL DATA WHOSE EXPORT IS RESTRICTED BY THE ARMS EXPORT CONTROL ACT (TITLE 22, U.S.C., SEC 2751, et seq.) OR THE EXPORT ADMINISTRATION ACT OF 1979, AS AMENDED, TITLE 50, U.S.C., APP. 2401 et seq. OR THE ATOMIC ENERGY ACT OF 1958. VIOLATIONS OF THESE EXPORT LAWS ARE SUBJECT TO SEVERE CRIMINAL PENALTIES. DISSEMINATE IN ACCORDANCE WITH PROVISIONS OF DOD DIRECTIVE 5230.25.

DESTRUCTION NOTICE - DESTROY BY ANY METHOD THAT WILL PREVENT DISCLOSURE OF CONTENTS OR RECONSTRUCTION OF THE DOCUMENT.

KANSAS CITY

NATIONAL SECURITY CAMPUS
 GLOBAL SECURITY

14520 BOTTS ROAD
 KANSAS CITY, MO 64147
 www.kcp.com

QUANTITY ABBREVIATIONS NA = NO QUANTITY FOR DOCUMENTS AR = AS REQUIRED FOR ASSEMBLY ARS = AS REQUIRED ALT = ALTERNATE	INTERPRET GEOMETRIC TOLERANCES PER: ASME Y14.5M-1994
UNLESS OTHERWISE SPECIFIED: DIMENSIONS ARE IN INCHES TOLERANCES: FRACTIONAL ± 1/8 ANGULAR, MACH ± 1° BEND ± 5° TWO PLACE DECIMAL ± .03 THREE PLACE DECIMAL ± .005 FOUR PLACE DECIMAL ± .0005	MATERIAL SEE NOTES
FINISH SEE NOTES	DO NOT SCALE DRAWING

NAME E. CLAYTON	DATE 7/10/2017	TITLE: WING AND FIN UNLOCK TOOL
CHECKED J. BARRY	7/10/2017	DWG. NO. 20057635
ENG APPR. E. CLAYTON	7/10/2017	PART. NO. 20057635
CUSTOMER		REV 4
CAGE: 14061	SCALE: 1:1	SHEET 1 OF 1
DWG. CLASSIFICATION UNCLASSIFIED	PART CLASSIFICATION UNCLASSIFIED	