

15/53
17/53vb

KZ05
ODW-5

S0-5

C38

1275
1276
1277

P1-RURA OCHRONNA (PRZEWIERTOWA)
Ø 100x10.0 L=14.3m

2xDM 80
C39
1180

C41

12,3

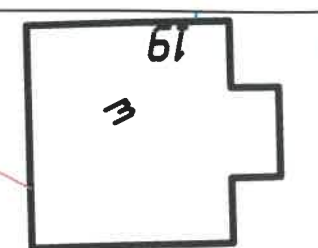
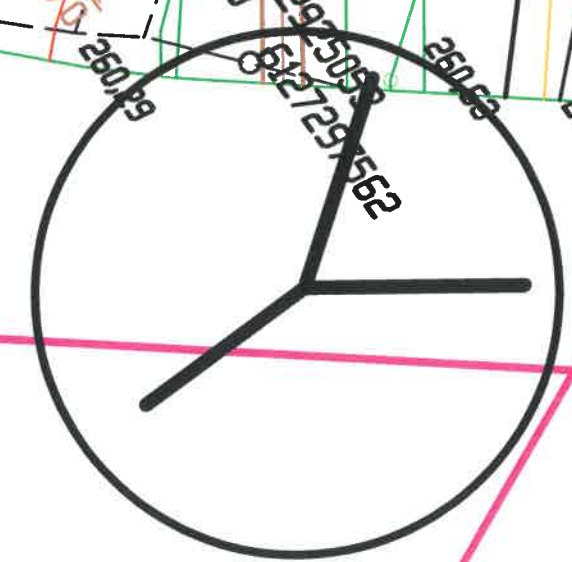

57

WYCZA

100 B

kd315

ks230

eNA

plbt.

Plasf.

k74

OK

k74

plbt.

162.7

250.19
250.29
250.52
250.56

250.69
250.70
250.74
250.77

250.84
250.87
250.90
250.93

250.95
250.98
251.00
251.03

251.06
251.09
251.12
251.15

251.18
251.21
251.24
251.27

251.30
251.33
251.36
251.39

251.42
251.45
251.48
251.51

251.54
251.57
251.60
251.63

251.66
251.69
251.72
251.75

5.0

5.0

5.0

5.0

5.0

5.0

5.0

5.0

11.0

11.0

11.0

11.0

11.0

11.0

11.0

11.0

5.0

5.0

5.0

5.0

5.0

5.0

5.0

5.0

5.0

5.0

5.0

5.0

5.0

5.0

5.0

5.0

5.0

5.0

5.0

5.0

5.0

5.0

5.0

5.0

5.0

5.0

5.0

5.0

5.0

5.0

5.0

5.0

5.0

5.0

5.0

5.0

5.0

5.0

5.0

5.0

5.0

5.0

5.0

5.0

5.0

5.0

5.0

5.0