

ZAKŁAD USŁUG TECHNICZNYCH PROSBEĐ s.c. Os. Słowackiego 22/9 64 - 980 Trzciánka		INWESTOR Gmina Wieleń, ul. Kościuszki 34, 64-730 Wieleń	
NAZWA Budowa sieci wodociągowej rozdzielczej wraz z przyłączami dla wsi Hamrzesko, Biała i Mężyk, gm. Wieleń		ZADANIA	
OBIEKT Sieć wodociągowa rozdzielcza		Przyłącza wodociągowe	
NAZWA RYSUNKU		Schematy węzłów wodociągowych	
OPRACOWAŁ	mgr inż. Tomasz Bednarczyk	PROJEKTOWAŁA	mgr inż. Justyna Markowicz upr. nr WKP/0125/POOS/07
SKALA		DATA	
01/2017		NR RYS	

5°
5°
5°

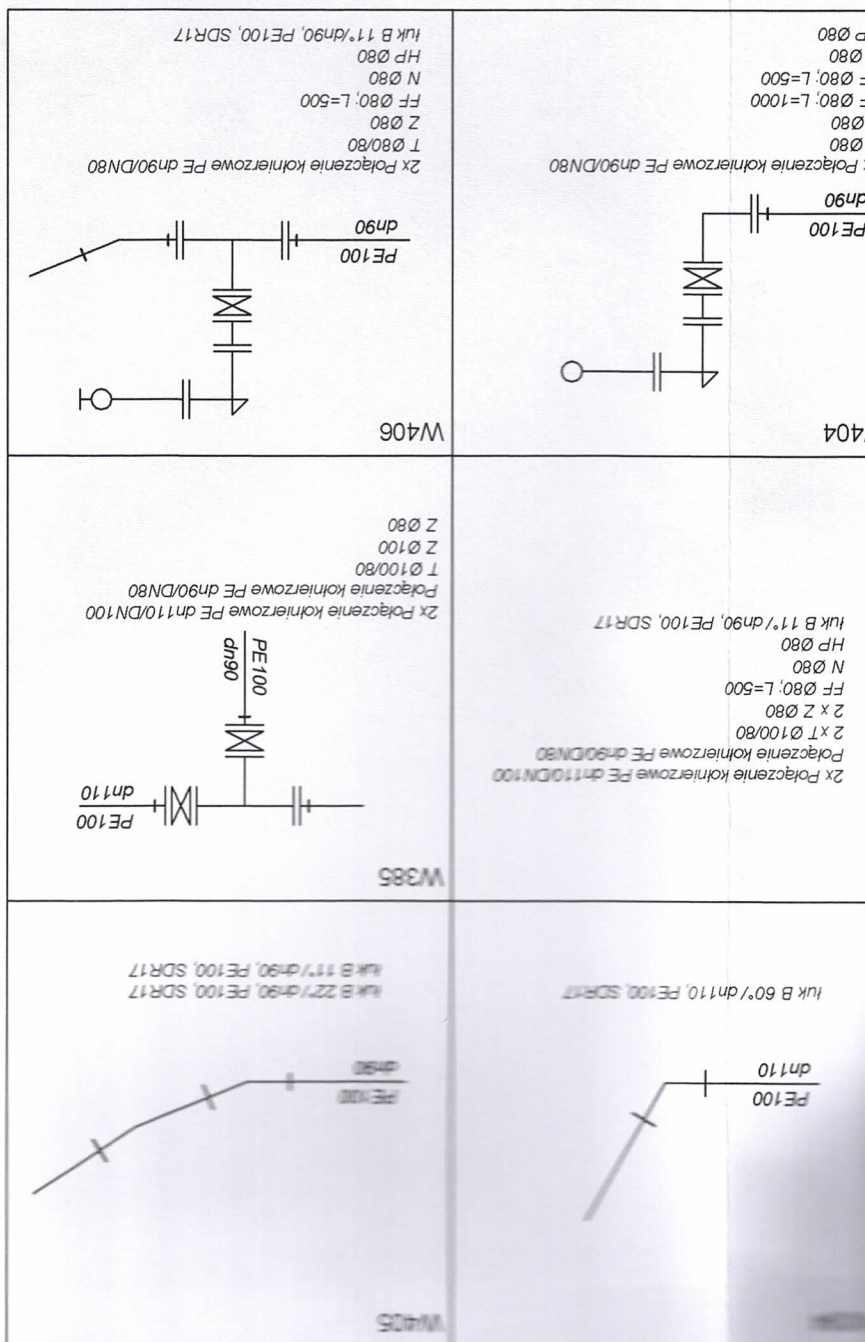

**UWAGI:**  
 1/ Oznaczenia i uwagi jak na rys. nr 32  
 2/ Dopuszcza się zastosowanie innych rozwiązań konstrukcyjnych i materiałowych węzłów technologicznych.

W412	2°	W424	3°	W401	4°	W425
------	----	------	----	------	----	------

ZALAMANIE TRASY - KĄTY NATURALNE dn90 PE

W359, W369, W370, W371, W375, W380, W395	2°	W357, W358, W392	3°	W361, W373, W389,	4°	W362, W397
--	----	------------------	----	-------------------	----	------------

ZALAMANIE TRASY - KĄTY NATURALNE dn110 PE

W402	<p>2x Polaczenie kohnierzowe PE dn90/DN80</p> <p>HP Ø80 N Ø80 Z Ø80 T Ø80/80</p>	W398	<p>Polaczenie kohnierzowe PE dn110/DN100</p> <p>2 x T Ø100/80 X Ø100 2 x Z Ø80 HP Ø80</p> <p>luk B 60°/dn90, PE100, SDR17</p> <p>HP Ø80 N Ø80 FF Ø80, L=500 FF Ø80, L=1000 Z Ø80 Q Ø80</p> <p>2x Polaczenie kohnierzowe PE dn90/DN80</p>	W404	<p>2x Polaczenie kohnierzowe PE dn110/DN100</p> <p>2 x T Ø100/80 X Ø100 2 x Z Ø80 HP Ø80</p> <p>luk B 60°/dn90, PE100, SDR17</p> <p>HP Ø80 N Ø80 FF Ø80, L=500 FF Ø80, L=1000 Z Ø80 Q Ø80</p> <p>2x Polaczenie kohnierzowe PE dn90/DN80</p>
------	--	------	--	------	---

W379, W415, W420	<p>2x Polaczenie kohnierzowe PE dn90/DN80</p> <p>HP Ø80 N Ø80 Z Ø80 Q Ø80</p>	W422, W427	<p>2x Polaczenie kohnierzowe PE dn90/DN80</p> <p>HP Ø80 N Ø80 2 x FF Ø80, L=500 Z Ø80 Q Ø80</p>	W376	<p>2x Polaczenie kohnierzowe PE dn110/DN100</p> <p>2 x T Ø100/80 FF Ø80, L=500 N Ø80 HP Ø80</p> <p>luk B 11°/dn110</p>
------------------	---	------------	---	------	--

W378, W403, W407, W409, W410, W418	<p>luk B 90°/dn90, PE100, SDR17</p>	W414	<p>luk B 60°/dn90, PE100, SDR17</p>	W387	<p>luk B 22°/dn110, PE100, SDR17</p>	W394	<p>luk B 60°/dn110</p>
------------------------------------	-------------------------------------	------	-------------------------------------	------	--------------------------------------	------	------------------------

W416	1°
W412	

W390	1°
W359, W36	

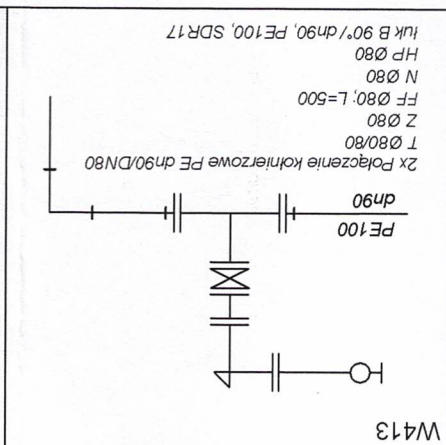
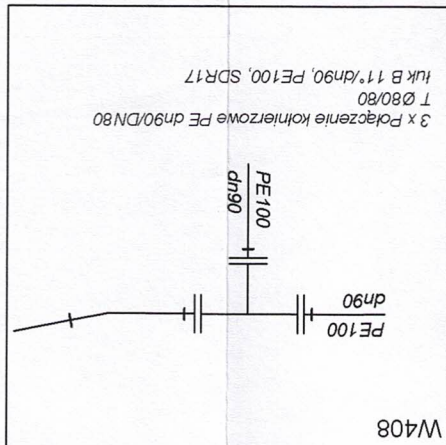
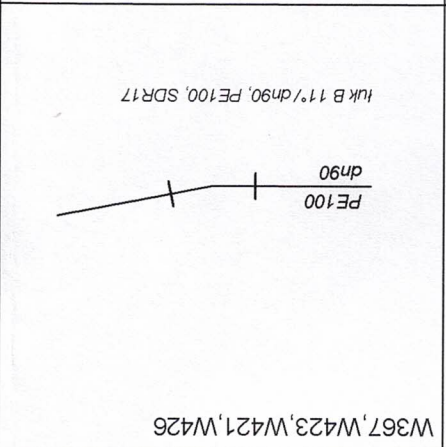
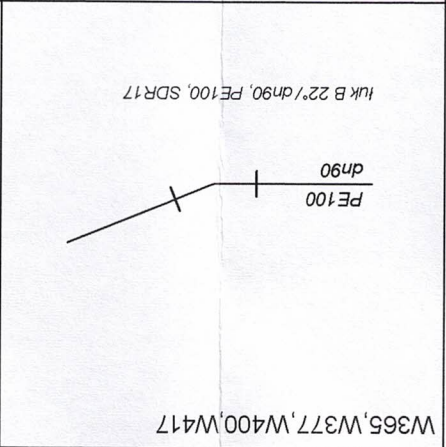
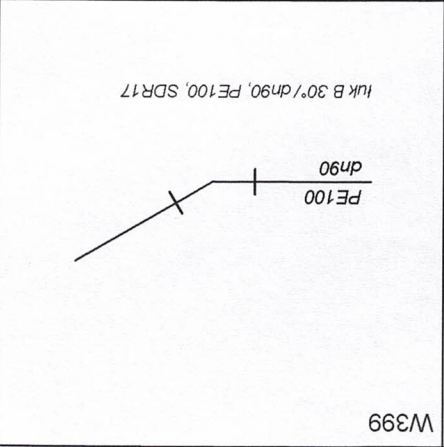
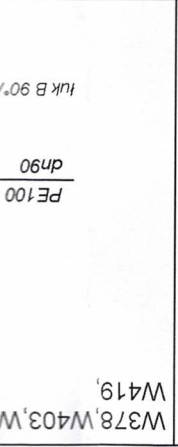
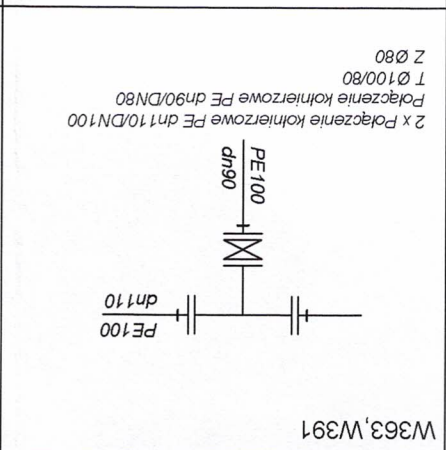
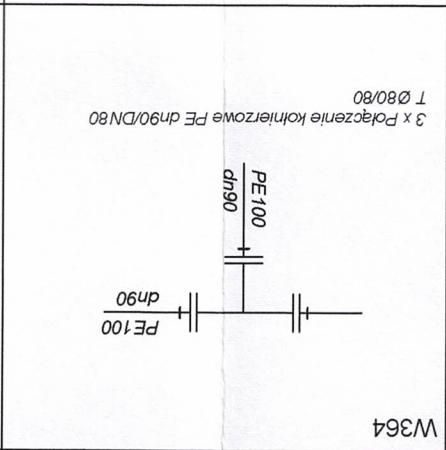
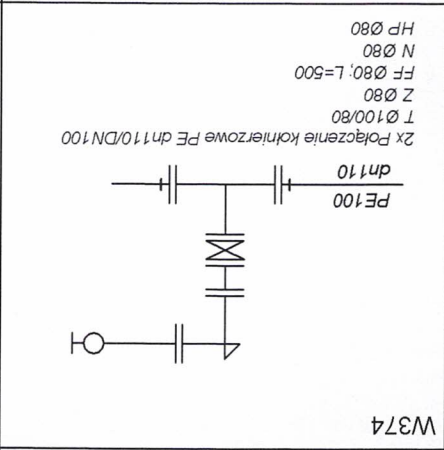
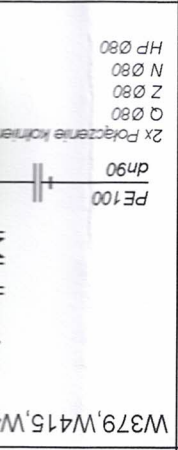
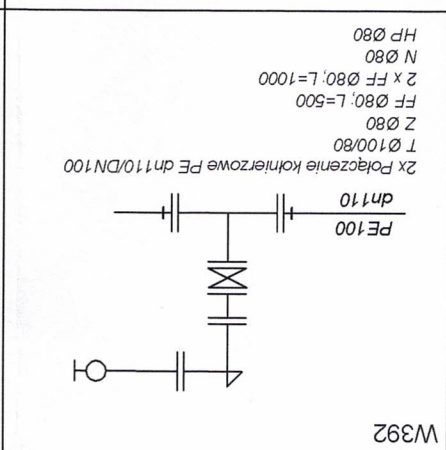
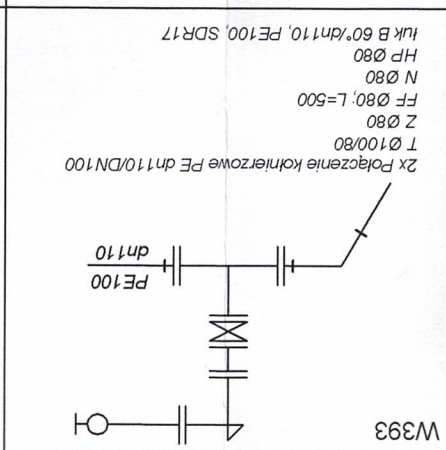
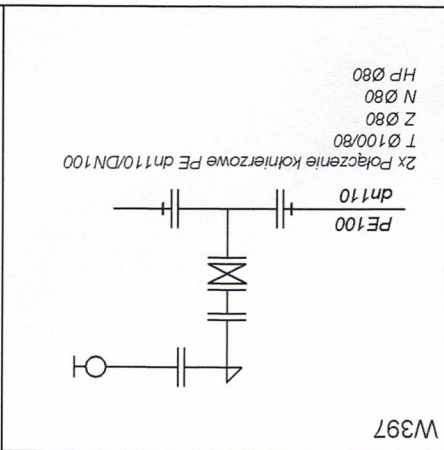
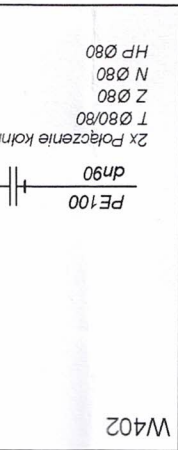

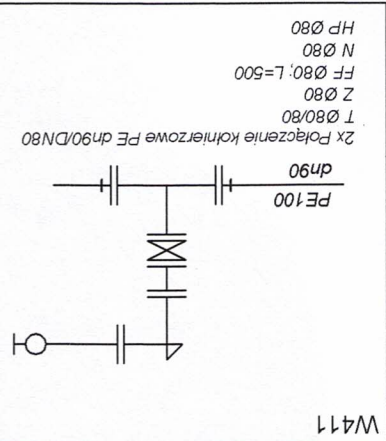

2x Polażenie kohnierowe PE dn90/DN80  
 T Ø80/80  
 Z Ø80  
 FF Ø80; L=500  
 N Ø80  
 HP Ø80

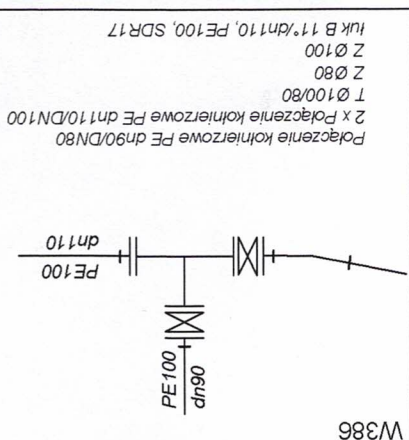

Polażenie kohnierowe PE dn90/DN80  
 2x Polażenie kohnierowe PE dn110/DN100  
 T Ø100/80  
 Z Ø80  
 FF Ø80; L=500  
 N Ø80  
 HP Ø80

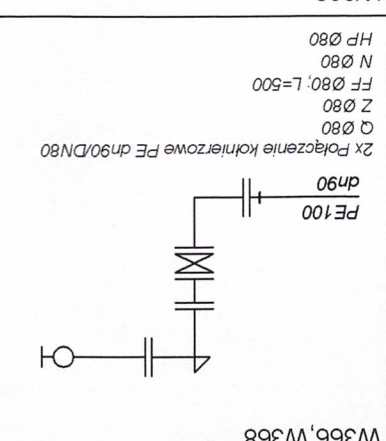

2x Polażenie kohnierowe PE dn90/DN80  
 Q Ø80  
 Z Ø80  
 FF Ø80; L=500  
 N Ø80  
 HP Ø80

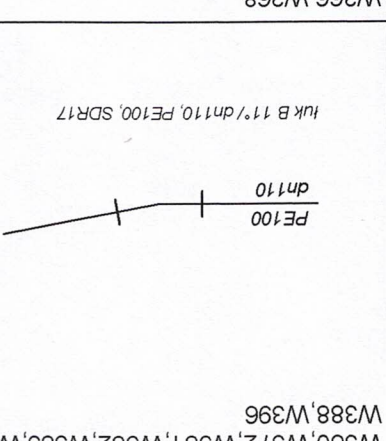

luk B 11'/dn110, PE100, SDR17

W360, W372, W381, W382, W383, W384  
 W388, W396

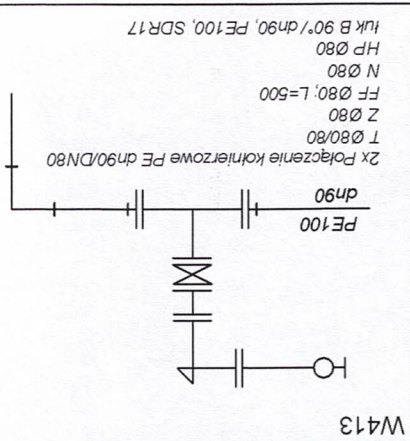

2x Polażenie kohnierowe PE dn90/DN80  
 T Ø80/80  
 Z Ø80  
 FF Ø80; L=500  
 N Ø80  
 HP Ø80

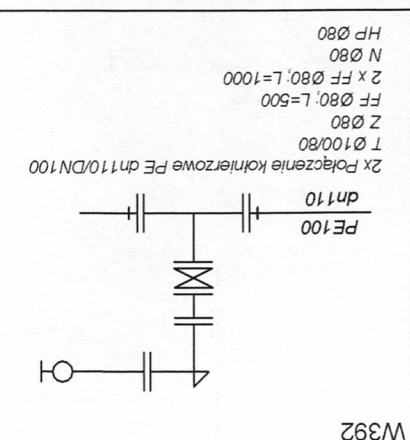

2x Polażenie kohnierowe PE dn110/DN100  
 T Ø100/80  
 Z Ø80  
 FF Ø80; L=500  
 N Ø80  
 HP Ø80

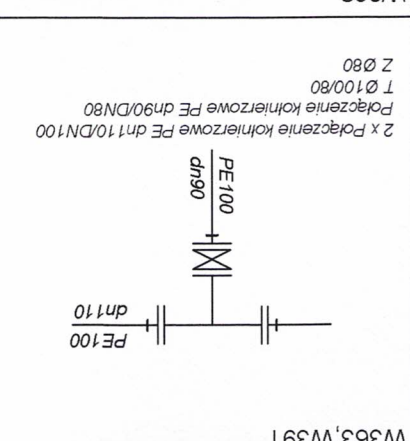

2x Polażenie kohnierowe PE dn110/DN100  
 Polażenie kohnierowe PE dn90/DN80  
 T Ø100/80  
 Z Ø80

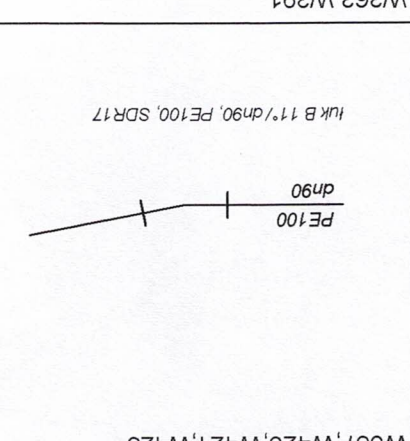

luk B 11'/dn90, PE100, SDR17

W367, W423, W421, W426

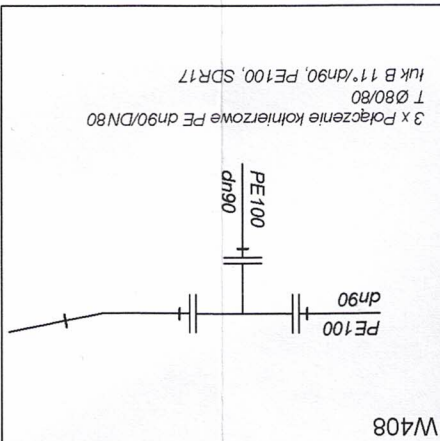

3x Polażenie kohnierowe PE dn90/DN80  
 T Ø80/80  
 luk B 11'/dn90, PE100, SDR17

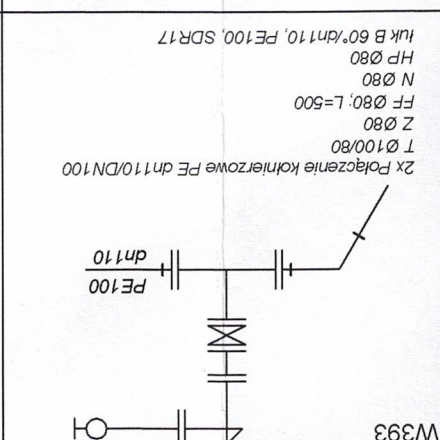

2x Polażenie kohnierowe PE dn110/DN100  
 T Ø100/80  
 Z Ø80  
 FF Ø80; L=500  
 N Ø80  
 HP Ø80

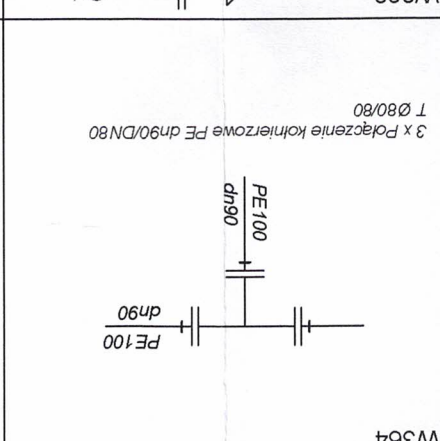

3x Polażenie kohnierowe PE dn90/DN80  
 T Ø80/80

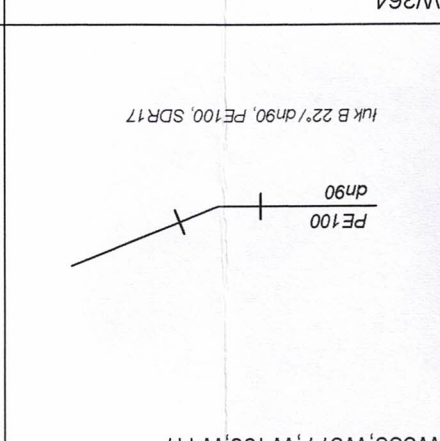

luk B 22'/dn90, PE100, SDR17

W365, W377, W400, W417