



MAPA SYTUACYJNO WYSOKOŚCIOWA

SKALA: 1:1000
 Obręb: ANTONINA
 Arkusz Nr: 6.148.30.04.1
 Działka Nr: 180/1, 187/1, 187/2, 187/3, 187/4, 187/5, 187/6, 187/7, 187/8, 187/9, 187/10, 187/11, 187/12, 187/13, 187/14, 187/15, 187/16, 187/17, 187/18, 187/19, 187/20, 187/21, 187/22, 187/23, 187/24, 187/25, 187/26, 187/27, 187/28, 187/29, 187/30, 187/31, 187/32, 187/33, 187/34, 187/35, 187/36, 187/37, 187/38, 187/39, 187/40, 187/41, 187/42, 187/43, 187/44, 187/45, 187/46, 187/47, 187/48, 187/49, 187/50, 187/51, 187/52, 187/53, 187/54, 187/55, 187/56, 187/57, 187/58, 187/59, 187/60, 187/61, 187/62, 187/63, 187/64, 187/65, 187/66, 187/67, 187/68, 187/69, 187/70, 187/71, 187/72, 187/73, 187/74, 187/75, 187/76, 187/77, 187/78, 187/79, 187/80, 187/81, 187/82, 187/83, 187/84, 187/85, 187/86, 187/87, 187/88, 187/89, 187/90, 187/91, 187/92, 187/93, 187/94, 187/95, 187/96, 187/97, 187/98, 187/99, 187/100, 187/101, 187/102, 187/103, 187/104, 187/105, 187/106, 187/107, 187/108, 187/109, 187/110, 187/111, 187/112, 187/113, 187/114, 187/115, 187/116, 187/117, 187/118, 187/119, 187/120, 187/121, 187/122, 187/123, 187/124, 187/125, 187/126, 187/127, 187/128, 187/129, 187/130, 187/131, 187/132, 187/133, 187/134, 187/135, 187/136, 187/137, 187/138, 187/139, 187/140, 187/141, 187/142, 187/143, 187/144, 187/145, 187/146, 187/147, 187/148, 187/149, 187/150, 187/151, 187/152, 187/153, 187/154, 187/155, 187/156, 187/157, 187/158, 187/159, 187/160, 187/161, 187/162, 187/163, 187/164, 187/165, 187/166, 187/167, 187/168, 187/169, 187/170, 187/171, 187/172, 187/173, 187/174, 187/175, 187/176, 187/177, 187/178, 187/179, 187/180, 187/181, 187/182, 187/183, 187/184, 187/185, 187/186, 187/187, 187/188, 187/189, 187/190, 187/191, 187/192, 187/193, 187/194, 187/195, 187/196, 187/197, 187/198, 187/199, 187/200, 187/201, 187/202, 187/203, 187/204, 187/205, 187/206, 187/207, 187/208, 187/209, 187/210, 187/211, 187/212, 187/213, 187/214, 187/215, 187/216, 187/217, 187/218, 187/219, 187/220, 187/221, 187/222, 187/223, 187/224, 187/225, 187/226, 187/227, 187/228, 187/229, 187/230, 187/231, 187/232, 187/233, 187/234, 187/235, 187/236, 187/237, 187/238, 187/239, 187/240, 187/241, 187/242, 187/243, 187/244, 187/245, 187/246, 187/247, 187/248, 187/249, 187/250, 187/251, 187/252, 187/253, 187/254, 187/255, 187/256, 187/257, 187/258, 187/259, 187/260, 187/261, 187/262, 187/263, 187/264, 187/265, 187/266, 187/267, 187/268, 187/269, 187/270, 187/271, 187/272, 187/273, 187/274, 187/275, 187/276, 187/277, 187/278, 187/279, 187/280, 187/281, 187/282, 187/283, 187/284, 187/285, 187/286, 187/287, 187/288, 187/289, 187/290, 187/291, 187/292, 187/293, 187/294, 187/295, 187/296, 187/297, 187/298, 187/299, 187/300, 187/301, 187/302, 187/303, 187/304, 187/305, 187/306, 187/307, 187/308, 187/309, 187/310, 187/311, 187/312, 187/313, 187/314, 187/315, 187/316, 187/317, 187/318, 187/319, 187/320, 187/321, 187/322, 187/323, 187/324, 187/325, 187/326, 187/327, 187/328, 187/329, 187/330, 187/331, 187/332, 187/333, 187/334, 187/335, 187/336, 187/337, 187/338, 187/339, 187/340, 187/341, 187/342, 187/343, 187/344, 187/345, 187/346, 187/347, 187/348, 187/349, 187/350, 187/351, 187/352, 187/353, 187/354, 187/355, 187/356, 187/357, 187/358, 187/359, 187/360, 187/361, 187/362, 187/363, 187/364, 187/365, 187/366, 187/367, 187/368, 187/369, 187/370, 187/371, 187/372, 187/373, 187/374, 187/375, 187/376, 187/377, 187/378, 187/379, 187/380, 187/381, 187/382, 187/383, 187/384, 187/385, 187/386, 187/387, 187/388, 187/389, 187/390, 187/391, 187/392, 187/393, 187/394, 187/395, 187/396, 187/397, 187/398, 187/399, 187/400, 187/401, 187/402, 187/403, 187/404, 187/405, 187/406, 187/407, 187/408, 187/409, 187/410, 187/411, 187/412, 187/413, 187/414, 187/415, 187/416, 187/417, 187/418, 187/419, 187/420, 187/421, 187/422, 187/423, 187/424, 187/425, 187/426, 187/427, 187/428, 187/429, 187/430, 187/431, 187/432, 187/433, 187/434, 187/435, 187/436, 187/437, 187/438, 187/439, 187/440, 187/441, 187/442, 187/443, 187/444, 187/445, 187/446, 187/447, 187/448, 187/449, 187/450, 187/451, 187/452, 187/453, 187/454, 187/455, 187/456, 187/457, 187/458, 187/459, 187/460, 187/461, 187/462, 187/463, 187/464, 187/465, 187/466, 187/467, 187/468, 187/469, 187/470, 187/471, 187/472, 187/473, 187/474, 187/475, 187/476, 187/477, 187/478, 187/479, 187/480, 187/481, 187/482, 187/483, 187/484, 187/485, 187/486, 187/487, 187/488, 187/489, 187/490, 187/491, 187/492, 187/493, 187/494, 187/495, 187/496, 187/497, 187/498, 187/499, 187/500, 187/501, 187/502, 187/503, 187/504, 187/505, 187/506, 187/507, 187/508, 187/509, 187/510, 187/511, 187/512, 187/513, 187/514, 187/515, 187/516, 187/517, 187/518, 187/519, 187/520, 187/521, 187/522, 187/523, 187/524, 187/525, 187/526, 187/527, 187/528, 187/529, 187/530, 187/531, 187/532, 187/533, 187/534, 187/535, 187/536, 187/537, 187/538, 187/539, 187/540, 187/541, 187/542, 187/543, 187/544, 187/545, 187/546, 187/547, 187/548, 187/549, 187/550, 187/551, 187/552, 187/553, 187/554, 187/555, 187/556, 187/557, 187/558, 187/559, 187/560, 187/561, 187/562, 187/563, 187/564, 187/565, 187/566, 187/567, 187/568, 187/569, 187/570, 187/571, 187/572, 187/573, 187/574, 187/575, 187/576, 187/577, 187/578, 187/579, 187/580, 187/581, 187/582, 187/583, 187/584, 187/585, 187/586, 187/587, 187/588, 187/589, 187/590, 187/591, 187/592, 187/593, 187/594, 187/595, 187/596, 187/597, 187/598, 187/599, 187/600, 187/601, 187/602, 187/603, 187/604, 187/605, 187/606, 187/607, 187/608, 187/609, 187/610, 187/611, 187/612, 187/613, 187/614, 187/615, 187/616, 187/617, 187/618, 187/619, 187/620, 187/621, 187/622, 187/623, 187/624, 187/625, 187/626, 187/627, 187/628, 187/629, 187/630, 187/631, 187/632, 187/633, 187/634, 187/635, 187/636, 187/637, 187/638, 187/639, 187/640, 187/641, 187/642, 187/643, 187/644, 187/645, 187/646, 187/647, 187/648, 187/649, 187/650, 187/651, 187/652, 187/653, 187/654, 187/655, 187/656, 187/657, 187/658, 187/659, 187/660, 187/661, 187/662, 187/663, 187/664, 187/665, 187/666, 187/667, 187/668, 187/669, 187/670, 187/671, 187/672, 187/673, 187/674, 187/675, 187/676, 187/677, 187/678, 187/679, 187/680, 187/681, 187/682, 187/683, 187/684, 187/685, 187/686, 187/687, 187/688, 187/689, 187/690, 187/691, 187/692, 187/693, 187/694, 187/695, 187/696, 187/697, 187/698, 187/699, 187/700, 187/701, 187/702, 187/703, 187/704, 187/705, 187/706, 187/707, 187/708, 187/709, 187/710, 187/711, 187/712, 187/713, 187/714, 187/715, 187/716, 187/717, 187/718, 187/719, 187/720, 187/721, 187/722, 187/723, 187/724, 187/725, 187/726, 187/727, 187/728, 187/729, 187/730, 187/731, 187/732, 187/733, 187/734, 187/735, 187/736, 187/737, 187/738, 187/739, 187/740, 187/741, 187/742, 187/743, 187/744, 187/745, 187/746, 187/747, 187/748, 187/749, 187/750, 187/751, 187/752, 187/753, 187/754, 187/755, 187/756, 187/757, 187/758, 187/759, 187/760, 187/761, 187/762, 187/763, 187/764, 187/765, 187/766, 187/767, 187/768, 187/769, 187/770, 187/771, 187/772, 187/773, 187/774, 187/775, 187/776, 187/777, 187/778, 187/779, 187/780, 187/781, 187/782, 187/783, 187/784, 187/785, 187/786, 187/787, 187/788, 187/789, 187/790, 187/791, 187/792, 187/793, 187/794, 187/795, 187/796, 187/797, 187/798, 187/799, 187/800, 187/801, 187/802, 187/803, 187/804, 187/805, 187/806, 187/807, 187/808, 187/809, 187/810, 187/811, 187/812, 187/813, 187/814, 187/815, 187/816, 187/817, 187/818, 187/819, 187/820, 187/821, 187/822, 187/823, 187/824, 187/825, 187/826, 187/827, 187/828, 187/829, 187/830, 187/831, 187/832, 187/833, 187/834, 187/835, 187/836, 187/837, 187/838, 187/839, 187/840, 187/841, 187/842, 187/843, 187/844, 187/845, 187/846, 187/847, 187/848, 187/849, 187/850, 187/851, 187/852, 187/853, 187/854, 187/855, 187/856, 187/857, 187/858, 187/859, 187/860, 187/861, 187/862, 187/863, 187/864, 187/865, 187/866, 187/867, 187/868, 187/869, 187/870, 187/871, 187/872, 187/873, 187/874, 187/875, 187/876, 187/877, 187/878, 187/879, 187/880, 187/881, 187/882, 187/883, 187/884, 187/885, 187/886, 187/887, 187/888, 187/889, 187/890, 187/891, 187/892, 187/893, 187/894, 187/895, 187/896, 187/897, 187/898, 187/899, 187/900, 187/901, 187/902, 187/903, 187/904, 187/905, 187/906, 187/907, 187/908, 187/909, 187/910, 187/911, 187/912, 187/913, 187/914, 187/915, 187/916, 187/917, 187/918, 187/919, 187/920, 187/921, 187/922, 187/923, 187/924, 187/925, 187/926, 187/927, 187/928, 187/929, 187/930, 187/931, 187/932, 187/933, 187/934, 187/935, 187/936, 187/937, 187/938, 187/939, 187/940, 187/941, 187/942, 187/943, 187/944, 187/945, 187/946, 187/947, 187/948, 187/949, 187/950, 187/951, 187/952, 187/953, 187/954, 187/955, 187/956, 187/957, 187/958, 187/959, 187/960, 187/961, 187/962, 187/963, 187/964, 187/965, 187/966, 187/967, 187/968, 187/969, 187/970, 187/971, 187/972, 187/973, 187/974, 187/975, 187/976, 187/977, 187/978, 187/979, 187/980, 187/981, 187/982, 187/983, 187/984, 187/985, 187/986, 187/987, 187/988, 187/989, 187/990, 187/991, 187/992, 187/993, 187/994, 187/995, 187/996, 187/997, 187/998, 187/999, 187/1000

Poświadczam się zgodnie z niniejszą kopią z treścią materiału państwowego zasobu geodezyjnego i kartograficznego

Organ prowadzący państwowy zasób geodezyjny i kartograficzny	STAROSTA PAJĘCZAŃSKI
Nazwa materiału zasobu	MAPA SYT-WYS
Identyfikator ewidencyjny materiału zasobu	GN-6621.2287.2022
Data wykonania kopii	2022-04-29
Imię, nazwisko i podpis osoby reprezentującej organ	INSPEKTOR ds. Ośrodka Dokumentacji Geodezyjnej i Kartograficznej <i>Margorzata Chudziak</i>

 pobocze
 jezdnia

Mapa nieaktualna - nie może służyć do sporządzenia planu sytuacyjnego w związku z budową przyłączy: elektroenergetycznych, wodociągowych, kanalizacyjnych, gazowych, ciepłych i telekomunikacyjnych.
 „Art. 29a i 34 ustawy z dnia 7 lipca 1994r Prawo Budowlane Dz. U. 2016. 290 t.j. z 2016ze zmianami”

Wydano do celów opiniodawczych
 Mapa nie może służyć do celów projektowych

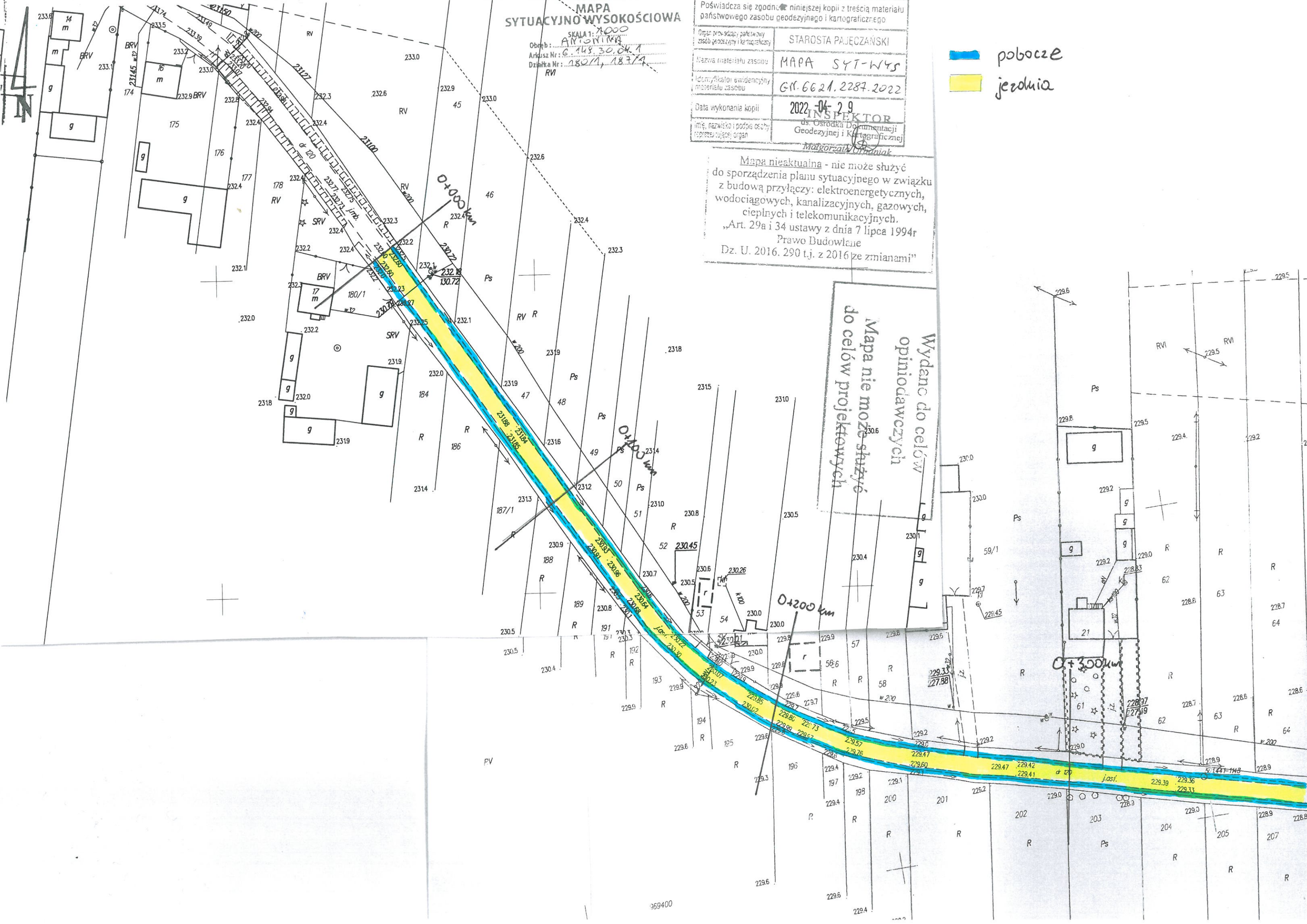

369400

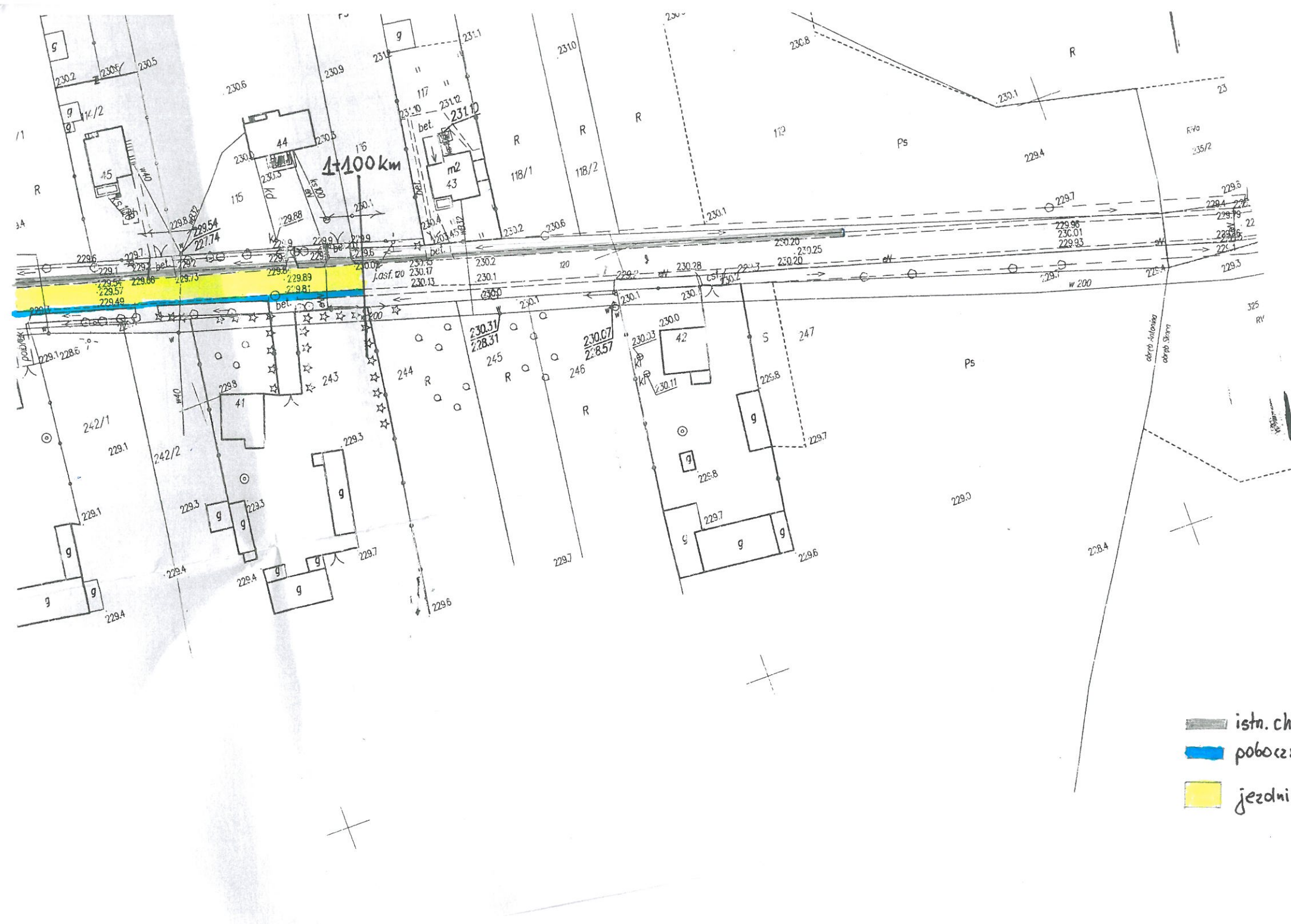

- istn. chodnik
- pobocza
- jezdnia